

# METAGENICS FITNESS

## Selectorized MF-L1000 line Combos Dual Function

### MF-L1003 Leg press/ Calf press



The Leg Press/Calf press is an essential component of your strength training routine that features biomechanically sound positioning and pressing angles with a maintenance-free stainless-steel rails that provide a smooth movement.

#### Specifications

Dimensions (L x W x H):

2070\*1120\*1460 mm

Product Weight: 683 lb (310 kg)

Weight Stack: 265 lb (120 kg)



SEATED LEG PRESS

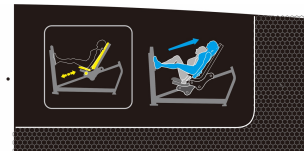

## MF-L1080 Lat pull / Seated Row



Lat Pulldown/ Seated row accommodates two exercises that target the entire back and rear shoulder muscle groups.

### Specifications

Dimensions (L x W x H):

2015\*1100\*2190 mm

Product Weight: 562 lb (255 kg)

Weight Stack: 220 lb (100kg)

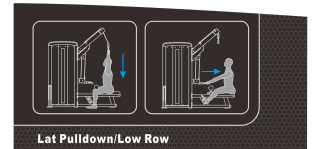

## MF-L1082 Multi press/ Chest & Shoulders



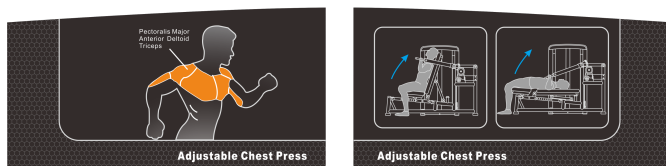

Multi-press for Chest & Shoulders  
Dual function machine to exercise shoulders and chest in different angles.

Specifications

Dimensions (L x W x H):

2010\*1400\*1460 mm

Product Weight: 507 lb (230 kg)

Weight Stack: 220 lb (100 kg)

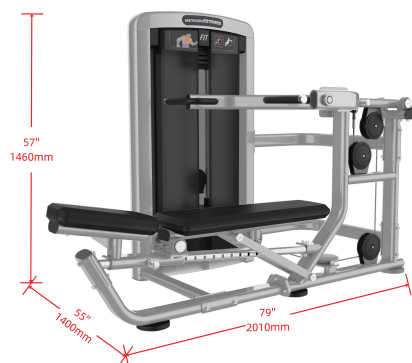

## MF-L1083 Biceps/Triceps



The Biceps/Triceps machine features two exercises in one space saving machine. Single seat adjustment ratchets for proper exercise positioning and optimal comfort.

Specifications

Dimensions (L x W x H):

1410\*1100\*1460mm

Product Weight: 481 lb (210 kg)

Weight Stack: 220 lb (100 kg)

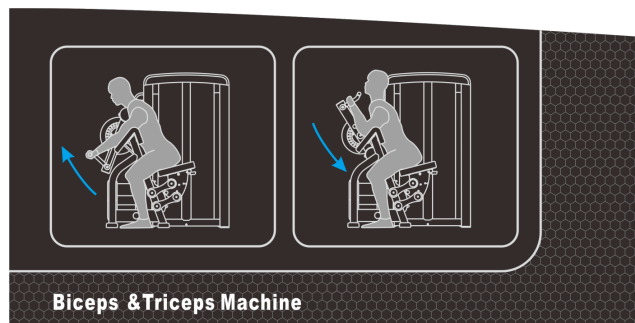

## MF-L1084A Leg extension/Prone leg curl

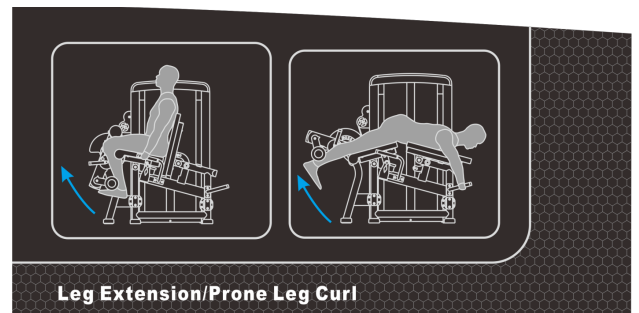

The space-saving design offers effective lower body strength training for both the hamstrings and quadriceps.

### Specifications

Dimensions (L x W x H):

1660\*1070\*1460mm

Product Weight: 507 lb (230 kg)

Weight Stack: 220 lb (100 kg)



## MF-L1081 Leg extension / seated leg curl

Dimensions L1310 W 1080 H 1460 mm

Product weight: 481 lbs (218 kgs)

Weigh stack: 220 lbs (100 kgs)



## MF-L1025 Inner/outer thigh

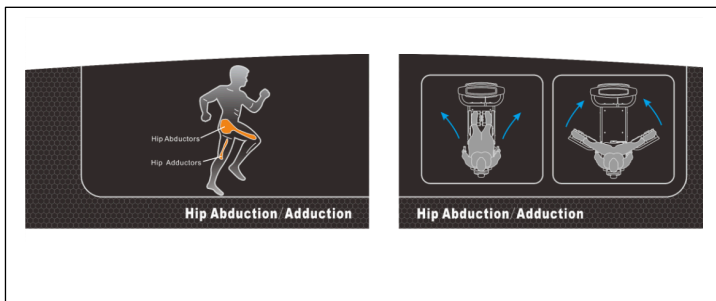

Inner & Outer Thigh utilizes a unique reversing mechanism that provides biomechanically correct resistance in both directions, resulting in a natural feel. An efficient two-in-one design saves valuable floor space.

### Specifications

Dimensions (L x W x H):

1650\*810\*1460 mm

Product Weight: 507 lb (230 kg)

Weight Stack: 220 lb (100 kg)

## Heavy stack

Our heavy stack is 260 lbs for any of the machines.

Metagenics Fitness Inc.  
[www.metagenics.ca](http://www.metagenics.ca)